

Soils Map

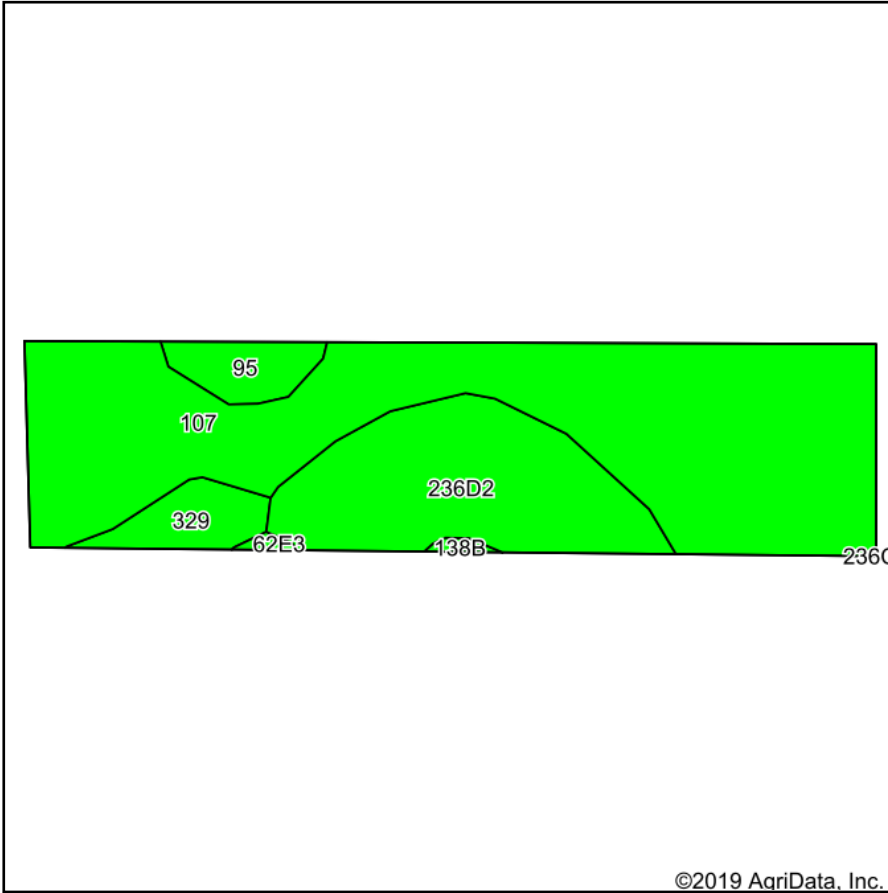

Soils data provided by USDA and NRCS.

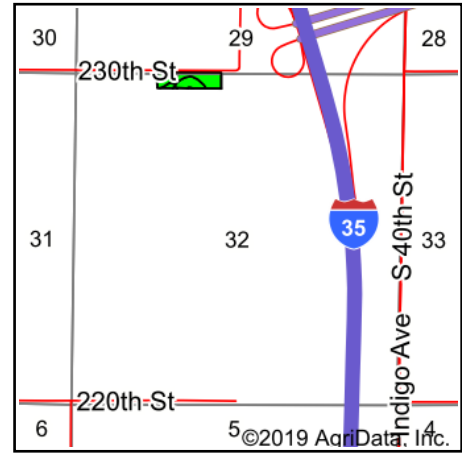

State: **Iowa**
 County: **Cerro Gordo**
 Location: **32-96N-21W**
 Township: **Lake**
 Acres: **5.98**
 Date: **12/11/2019**



Maps Provided By:



© AgriData, Inc. 2019

www.AgriDataInc.com



Area Symbol: IA033. Soil Area Version: 23										
Code	Soil Description	Acres	Percent of field	CSR2 Legend	Non-Irr Class *c	CSR2**	CSR	Barley	Oats	Spring wheat
107	Webster clay loam, 0 to 2 percent slopes	3.94	65.9%		Ilw	86	83			
236D2	Lester loam, 10 to 16 percent slopes, moderately eroded	1.49	24.9%		Ive	49	48			
329	Webster-Nicollet complex, 0 to 3 percent slopes	0.29	4.8%		Ilw	87	83			
95	Harps clay loam, 0 to 2 percent slopes	0.26	4.3%		Ilw	72	62			
Weighted Average						76.2	73.4	*-	*-	*-

**IA has updated the CSR values for each county to CSR2.

*c: Using Capabilities Class Dominant Condition Aggregation Method

Soils data provided by USDA and NRCS.